

2_MP_95.3-146.2.Median-Cable-Bernier\road-au design\14413_PD-13.dwg

**CABLE/W-BEAM ANCHOR
ASSEMBLY (SINGLE SIDED) REQ'D**
351+21.31 RT 11.72 TO
351+46.36 RT 11.68

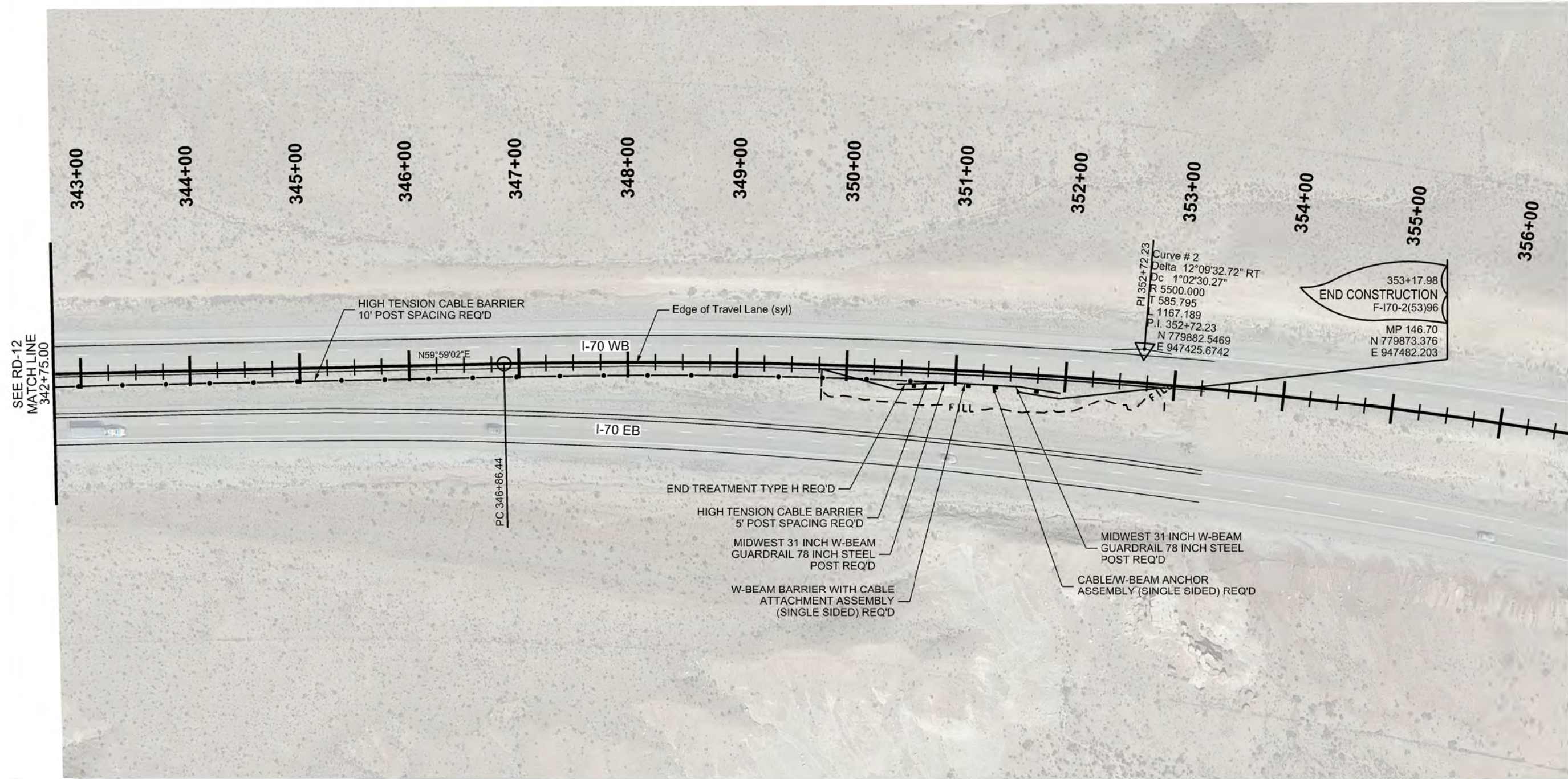

SHEET NO.		RD-13		PROJECT		I-70; MP 96.3-146.2.		<div>UTAH DEPARTMENT OF TRANSPORTATION</div> <div>JONES & DEMILLE ENGINEERING</div>										APPROVED				DRAWN BY		APD		9/14/2017				QC CHECKED BY		DR		PROFESSIONAL ENGINEER		DATE		APPROVED BY		NO.		DATE		REMARKS																																																																																																																																																																																																																																																																																																																																																																																																																																																																																																																																																																																																																																																																																																																																																																																																																																																																																																																																																																																																																																																																																																																																																																																																																			
				PROJECT NUMBER		F-170-2(53)96		PIN		14443		ROADWAY																																																																																																																																																																																																																																																																																																																																																																																																																																																																																																																																																																																																																																																																																																																																																																																																																																																																																																																																																																																																																																																																																																																																																																																																																																																			